

Lot 24, 7 High Street, Melton Mowbray,

Leicestershire LE13 0TT

For sale by Auction on 16th July 2026 (unless sold or withdrawn prior)



Freehold Former Bank Opportunity with Immediate Asset Management Opportunities

www.acutus.co.uk

Lot 24, 7 High Street, Melton Mowbray,

Leicestershire LE13 0TT

For sale by Auction on 16th July 2026 (unless sold or withdrawn prior)

Property Information

Freehold Former Bank Opportunity with Immediate Asset Management Opportunities

- Vacant former bank building
- Prominent position on High Street in Melton Mowbray town centre
- Approx. 331.36 sq. m. (3,567 sq. ft.) arranged over basement, ground and part first floors
- Potential for alternative uses (subject to planning)
- Nearby occupiers include Nationwide, HSBC, Iceland, Subway, Vision Express, Boots, Greggs and Costa Coffee
- Not elected for VAT

Lot

24

Auction

16th July 2026

Vacant Possession

Status

Available

Sector

Bank, Development

Auction Venue

Live Streamed Auction

On Behalf of NatWest Bank

Location

Miles

15 miles north-east of Leicester, 15 miles east of Loughborough, 19 miles south-east of Nottingham

Roads

A606, A607, A46, M1

Rail

Melton Mowbray Railway Station

Air

East Midlands Airport (approximately 25 miles north-west)

Situation

Melton Mowbray is a prosperous and historic market town located in the heart of Leicestershire. The property occupies a prominent position on a prime retail thoroughfare on the north-west side of the High Street, close to its junction with Nottingham Street. Nearby occupiers include Nationwide, HSBC, Subway, Vision Express, Boots, Greggs and Costa Coffee

Tenure

Freehold.

EPC

Band E.

Description

The property is a mid-terrace former bank building arranged over basement, ground and part first floors. The remainder of the first and second floors have been let on a long lease and is currently used for residential purposes, accessed via an external staircase.

VAT

Not Elected for VAT

Note

This sale is conditional and is subject to confirmation by the Seller. Please see further details within the Special Conditions of Sale.

DISCLAIMER

These particulars are for your convenience only. They do not form part of the contract and should not be relied upon. Please refer to the Acuitus website for the full terms and conditions of sale, details of the auction and any update and changes in guide price.

Lot 24, 7 High Street, Melton Mowbray,

Leicestershire LE13 0TT

For sale by Auction on 16th July 2026 (unless sold or withdrawn prior)



Tenancy & Accommodation

Floor	Use	Floor Areas Approx sq m	Floor Areas Approx sq ft	Possession
Basement	Retail	180.50	(1,943)	VACANT
Ground	Ancillary	84.75	(912)	
Part First	Ancillary	66.11	(712)	
Total		331.36	(3,567)	

N.B. The commercial floor areas stated above are those published by the Valuation Office Agency (www.voa.gov.uk).

Lot 24, 7 High Street, Melton Mowbray,

Leicestershire LE13 0TT

For sale by Auction on 16th July 2026 (unless sold or withdrawn prior)



**Lot 24, 7 High Street, Melton Mowbray,
Leicestershire LE13 0TT**

For sale by Auction on 16th July 2026 (unless sold or withdrawn prior)



Lot 24, 7 High Street, Melton Mowbray,

Leicestershire LE13 0TT

For sale by Auction on 16th July 2026 (unless sold or withdrawn prior)



Freehold Former Bank Opportunity with Immediate Asset Management Opportunities

www.acuitus.co.uk

Lot 24, 7 High Street, Melton Mowbray,

Leicestershire LE13 0TT

For sale by Auction on 16th July 2026 (unless sold or withdrawn prior)



Freehold Former Bank Opportunity with Immediate Asset Management Opportunities

www.acutus.co.uk

Lot 24, 7 High Street, Melton Mowbray,

Leicestershire LE13 0TT

For sale by Auction on 16th July 2026 (unless sold or withdrawn prior)



Freehold Former Bank Opportunity with Immediate Asset Management Opportunities

www.acuitus.co.uk

Lot 24, 7 High Street, Melton Mowbray, Leicestershire LE13 0TT

For sale by Auction on 16th July 2026 (unless sold or withdrawn prior)

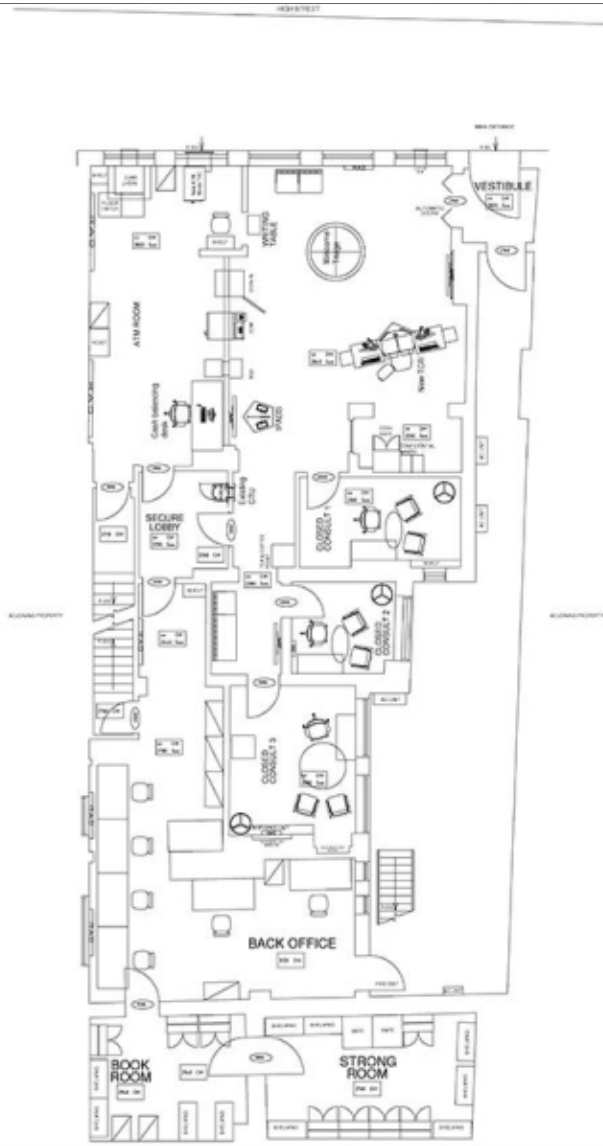

Property Services
This drawing is the copyright and property of NatWest Group plc. It shall not be copied or published without written consent.
Do not scale from this drawing.

Area / Description									
A	ATM ROOM	N	N	N	N	N	N	N	N
B	BACK OFFICE	N	N	N	N	N	N	N	N
C	BOOK ROOM	N	N	N	N	N	N	N	N
D	CONSOLE 1	N	N	N	N	N	N	N	N
E	CONSOLE 2	N	N	N	N	N	N	N	N
F	CONSOLE 3	N	N	N	N	N	N	N	N
G	CONSOLE 4	N	N	N	N	N	N	N	N
H	CONSOLE 5	N	N	N	N	N	N	N	N
I	CONSOLE 6	N	N	N	N	N	N	N	N
J	CONSOLE 7	N	N	N	N	N	N	N	N
K	CONSOLE 8	N	N	N	N	N	N	N	N
L	CONSOLE 9	N	N	N	N	N	N	N	N
M	CONSOLE 10	N	N	N	N	N	N	N	N
N	CONSOLE 11	N	N	N	N	N	N	N	N
O	CONSOLE 12	N	N	N	N	N	N	N	N
P	CONSOLE 13	N	N	N	N	N	N	N	N
Q	CONSOLE 14	N	N	N	N	N	N	N	N
R	CONSOLE 15	N	N	N	N	N	N	N	N
S	CONSOLE 16	N	N	N	N	N	N	N	N
T	CONSOLE 17	N	N	N	N	N	N	N	N
U	CONSOLE 18	N	N	N	N	N	N	N	N
V	CONSOLE 19	N	N	N	N	N	N	N	N
W	CONSOLE 20	N	N	N	N	N	N	N	N
X	CONSOLE 21	N	N	N	N	N	N	N	N
Y	CONSOLE 22	N	N	N	N	N	N	N	N
Z	CONSOLE 23	N	N	N	N	N	N	N	N
AA	CONSOLE 24	N	N	N	N	N	N	N	N
AB	CONSOLE 25	N	N	N	N	N	N	N	N
AC	CONSOLE 26	N	N	N	N	N	N	N	N
AD	CONSOLE 27	N	N	N	N	N	N	N	N
AE	CONSOLE 28	N	N	N	N	N	N	N	N
AF	CONSOLE 29	N	N	N	N	N	N	N	N
AG	CONSOLE 30	N	N	N	N	N	N	N	N
AH	CONSOLE 31	N	N	N	N	N	N	N	N
AI	CONSOLE 32	N	N	N	N	N	N	N	N
AJ	CONSOLE 33	N	N	N	N	N	N	N	N
AK	CONSOLE 34	N	N	N	N	N	N	N	N
AL	CONSOLE 35	N	N	N	N	N	N	N	N
AM	CONSOLE 36	N	N	N	N	N	N	N	N
AN	CONSOLE 37	N	N	N	N	N	N	N	N
AO	CONSOLE 38	N	N	N	N	N	N	N	N
AP	CONSOLE 39	N	N	N	N	N	N	N	N
AQ	CONSOLE 40	N	N	N	N	N	N	N	N
AR	CONSOLE 41	N	N	N	N	N	N	N	N
AS	CONSOLE 42	N	N	N	N	N	N	N	N
AT	CONSOLE 43	N	N	N	N	N	N	N	N
AU	CONSOLE 44	N	N	N	N	N	N	N	N
AV	CONSOLE 45	N	N	N	N	N	N	N	N
AW	CONSOLE 46	N	N	N	N	N	N	N	N
AX	CONSOLE 47	N	N	N	N	N	N	N	N
AY	CONSOLE 48	N	N	N	N	N	N	N	N
AZ	CONSOLE 49	N	N	N	N	N	N	N	N
BA	CONSOLE 50	N	N	N	N	N	N	N	N
BB	CONSOLE 51	N	N	N	N	N	N	N	N
BC	CONSOLE 52	N	N	N	N	N	N	N	N
BD	CONSOLE 53	N	N	N	N	N	N	N	N
BE	CONSOLE 54	N	N	N	N	N	N	N	N
BF	CONSOLE 55	N	N	N	N	N	N	N	N
BF	CONSOLE 56	N	N	N	N	N	N	N	N
BF	CONSOLE 57	N	N	N	N	N	N	N	N
BF	CONSOLE 58	N	N	N	N	N	N	N	N
BF	CONSOLE 59	N	N	N	N	N	N	N	N
BF	CONSOLE 60	N	N	N	N	N	N	N	N
BF	CONSOLE 61	N	N	N	N	N	N	N	N
BF	CONSOLE 62	N	N	N	N	N	N	N	N
BF	CONSOLE 63	N	N	N	N	N	N	N	N
BF	CONSOLE 64	N	N	N	N	N	N	N	N
BF	CONSOLE 65	N	N	N	N	N	N	N	N
BF	CONSOLE 66	N	N	N	N	N	N	N	N
BF	CONSOLE 67	N	N	N	N	N	N	N	N
BF	CONSOLE 68	N	N	N	N	N	N	N	N
BF	CONSOLE 69	N	N	N	N	N	N	N	N
BF	CONSOLE 70	N	N	N	N	N	N	N	N
BF	CONSOLE 71	N	N	N	N	N	N	N	N
BF	CONSOLE 72	N	N	N	N	N	N	N	N
BF	CONSOLE 73	N	N	N	N	N	N	N	N
BF	CONSOLE 74	N	N	N	N	N	N	N	N
BF	CONSOLE 75	N	N	N	N	N	N	N	N
BF	CONSOLE 76	N	N	N	N	N	N	N	N
BF	CONSOLE 77	N	N	N	N	N	N	N	N
BF	CONSOLE 78	N	N	N	N	N	N	N	N
BF	CONSOLE 79	N	N	N	N	N	N	N	N
BF	CONSOLE 80	N	N	N	N	N	N	N	N
BF	CONSOLE 81	N	N	N	N	N	N	N	N
BF	CONSOLE 82	N	N	N	N	N	N	N	N
BF	CONSOLE 83	N	N	N	N	N	N	N	N
BF	CONSOLE 84	N	N	N	N	N	N	N	N
BF	CONSOLE 85	N	N	N	N	N	N	N	N
BF	CONSOLE 86	N	N	N	N	N	N	N	N
BF	CONSOLE 87	N	N	N	N	N	N	N	N
BF	CONSOLE 88	N	N	N	N	N	N	N	N
BF	CONSOLE 89	N	N	N	N	N	N	N	N
BF	CONSOLE 90	N	N	N	N	N	N	N	N
BF	CONSOLE 91	N	N	N	N	N	N	N	N
BF	CONSOLE 92	N	N	N	N	N	N	N	N
BF	CONSOLE 93	N	N	N	N	N	N	N	N
BF	CONSOLE 94	N	N	N	N	N	N	N	N
BF	CONSOLE 95	N	N	N	N	N	N	N	N
BF	CONSOLE 96	N	N	N	N	N	N	N	N
BF	CONSOLE 97	N	N	N	N	N	N	N	N
BF	CONSOLE 98	N	N	N	N	N	N	N	N
BF	CONSOLE 99	N	N	N	N	N	N	N	N
BF	CONSOLE 100	N	N	N	N	N	N	N	N

NatWest Group

MELTON MOWBRAY
7 HIGH ST MELTON MOWBRAY
LEICESTERSHIRE, LE13 0TT

GROUND FLOOR
AS EXISTING

GENERAL ARRANGEMENT

NOT TO SCALE

DATE: 30/05/22

25/05/2022

Lot 24, 7 High Street, Melton Mowbray, Leicestershire LE13 0TT

For sale by Auction on 16th July 2026 (unless sold or withdrawn prior)



Property Services
This drawing is the copyright and property of NatWest Group plc. It must not be copied or published without written consent.
Do not scale from this drawing.

Area / Description	Area
A. COMMERCIAL	1,111.11
B. RESIDENTIAL	1,111.11
C. TOTAL	2,222.22

NatWest Group

MELTON MOWBRAY
7 HIGH ST, MELTON MOWBRAY
LEICESTERSHIRE, LE13 0TT

**FIRST FLOOR
AS EXISTING**

GENERAL ARRANGEMENT

NOT TO SCALE

DATE: 30/05/22

2026/01/01

Lot 24, 7 High Street, Melton Mowbray, Leicestershire LE13 0TT

For sale by Auction on 16th July 2026 (unless sold or withdrawn prior)

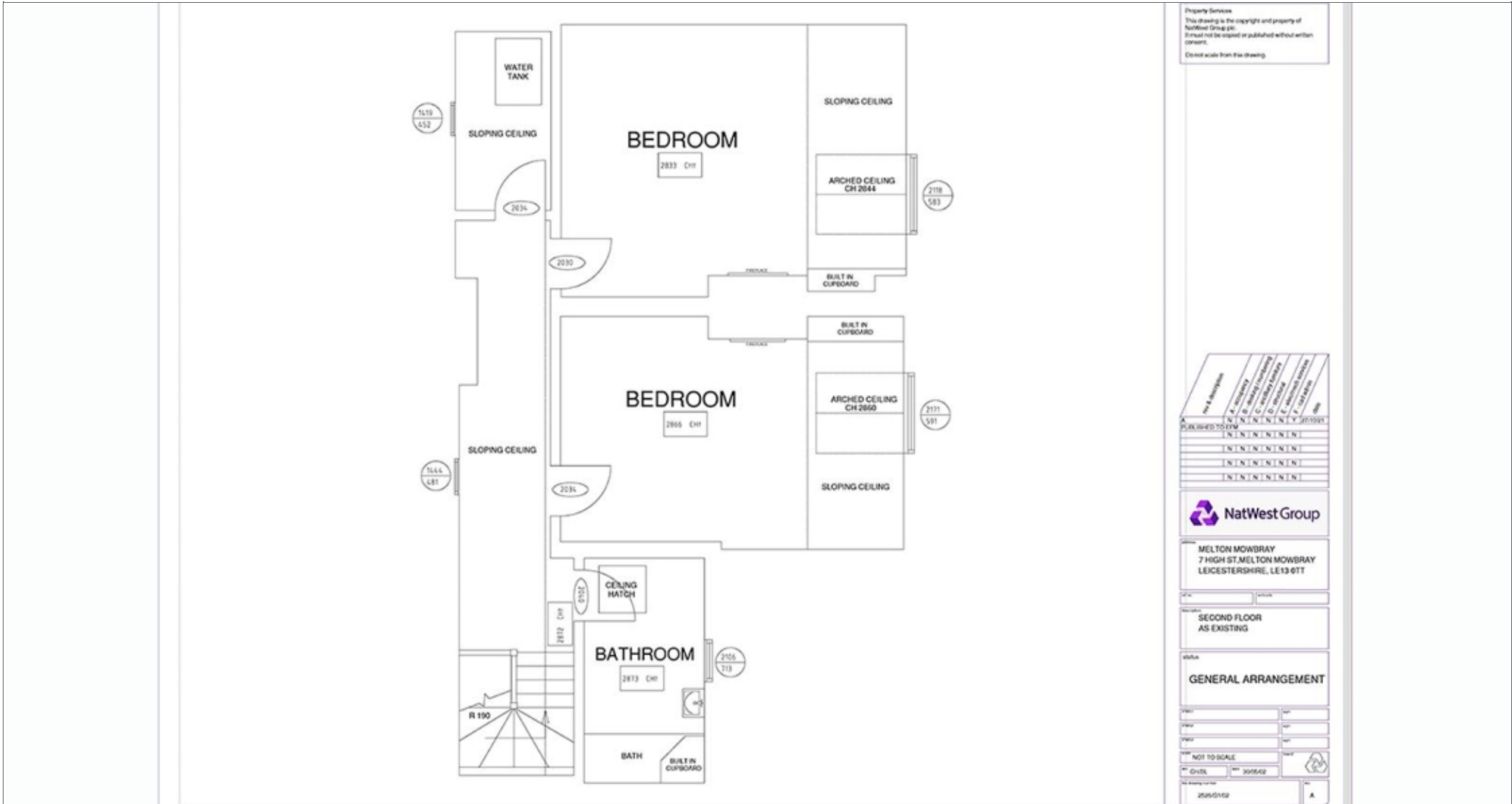

Property Services
This drawing is the copyright and property of
NatWest Group plc.
It must not be copied or published without written
consent.
Do not scale from this drawing.

Ref & Description	Quantity	Unit
1. 2833 CH	1	CH
2. 2118 581	1	581
3. 2866 CH	1	CH
4. 2111 581	1	581
5. 2813 CH	1	CH
6. 2105 513	1	513
7. 2812 CH	1	CH

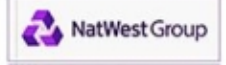

MELTON MOWBRAY
7 HIGH ST, MELTON MOWBRAY
LEICESTERSHIRE, LE13 0TT

Scale: 1:50

Description:
SECOND FLOOR
AS EXISTING

Title:
GENERAL ARRANGEMENT

NOT TO SCALE

Client: _____ Date: _____

Drawn: _____ Date: _____

Checked: _____ Date: _____

Scale: 1:50

Project: 2556/1102

Sheet: A

Lot 24, 7 High Street, Melton Mowbray, Leicestershire LE13 0TT

For sale by Auction on 16th July 2026 (unless sold or withdrawn prior)



Freehold Former Bank Opportunity with Immediate Asset Management Opportunities

www.acutus.co.uk

Lot 24, 7 High Street, Melton Mowbray,

Leicestershire LE13 0TT

For sale by Auction on 16th July 2026 (unless sold or withdrawn prior)



Contacts

Acuitus

Jon Skerry

+44 (0)20 7034 4863

+44 (0)7736 300 594

jon.skerry@acuitus.co.uk

Alexander Auterac

+44 (0)20 7034 4859

+44 (0)7713 135 034

alexander.auterac@acuitus.co.uk

Seller's Solicitors

DLA Piper UK LLP

City Square House, 11 Wellington Street

Leeds

LS1 4DL

Annie Khan

0113 3692026

annie.khan@dlapiper.com

Misrepresentation Act

Acuitus Limited, for themselves and for the vendors of this property, whose agents they are, give notice that

(i) the particulars and any further information communicated by any means to potential purchasers of the property described in the particulars, or their advisers, in connection with the possible sale of the property are provided solely for the purpose of assisting potential purchasers in deciding whether they wish to proceed with further investigation of the property and do not constitute either the whole or any part of an invitation, offer or contract for sale of the property;

(ii) all descriptions, dimensions, references to condition and necessary permissions for use and occupation and other details are given in good faith and are believed to be correct as at the date of the particulars (or the date of the relevant information if earlier). However, potential purchasers are not entitled to rely on them as statements or representations of fact but should satisfy themselves by searches, enquiries, surveys and inspections or otherwise with regard to the accuracy of such details. No responsibility or liability is or will be accepted by Acuitus Limited, the vendor(s) of the property or any of their respective subsidiaries, affiliates, directors, officers, representatives, employees, advisors, or agents for any loss or damage suffered by any party, resulting from reliance on the particulars or any other information communicated by any means to that party, or its advisers, in connection with the possible sale of the property.

No person in the employment of Acuitus Limited or the vendor(s) has authority to make or give any representation or warranty, express or implied, in relation to the property. References to Acuitus Limited include any joint agents acting with Acuitus Limited.

2024